

SCHIEBER AUS PRESSMESSING SC155

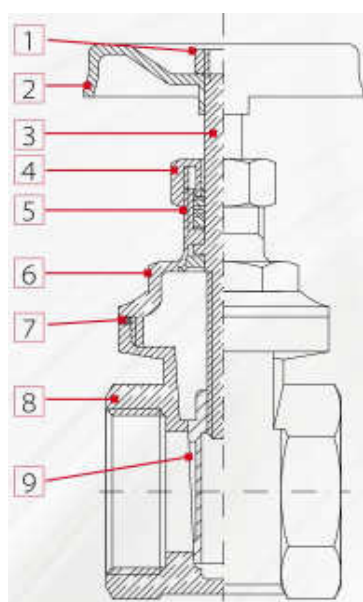

TECHNISCHE DATEN

Gehäuse: Messing CW617N
 Spindeldichtung: EPDM
 Metallgriff
 Gewinde: ISO228/1
 Betriebstemp.: 0°C – 120°C ohne Dampf



POS.	DESCRIZIONE/DESCRIPTION	Q.TA./N.	MATERIALE/MATERIAL
1	Dado / Nut	1	Ottone / Brass CW614N
2	Volantino / Handwheel	1	Acciaio / Steel
3	Asta / Stem	1	Ottone / Brass CW614N
4	Premistoppa / Gland	1	Ottone / Brass CW614N
5	Guarnizione / Washer	1	EPDM 90
6	Vitone / Bonnet	1	Ottone / Brass CW617N
7	Guarnizione / Washer	1	Fibra / Guarnital
8	Corpo / Body	1	Ottone stampato / Hot pressed brass CW617N
9	Tenuta / Seat	1	Ottone stampato / Hot pressed brass CW617N

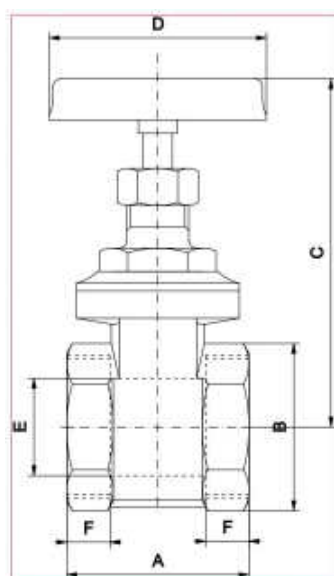

MISURE / SIZE	1/4"	3/8"	1/2"	3/4"	1"	1 1/4"	1 1/2"	2"	2 1/2"	3"	4"
DN	8	10	15	20	25	32	40	50	65	80	100
A (mm)	33	33	36	39	43	48	52	57	65	75	84
B (mm)	25	25	27	34	42	52	59	74	91	104	137
C (mm)	67	67	67	68	78	91	104	128	175	200	235
D (mm)	45	45	45	45	50	55	60	70	100	100	120
E (mm)	11	13	13,5	15,5	19	27	33	45	60	72	93
F (mm)	8	8	9	9	10	10	11	12	13	14	16
PRESS. ATMOSF. / WORK. PRESS. Kg/cm ² - bar	10	10	10	10	10	10	10	10	16	16	16
PRESS. ATMOSF. PSI LBS WORK. PRESS.	145	145	145	145	145	145	145	145	230	230	230

SCHIEBER AUS PRESSMESSING SC157



TECHNISCHE DATEN

Gehäuse: Messing CW617N
Spindeldichtung: EPDM
Metallgriff
Gewinde: ISO228/1
Betriebstemp.: 0°C – 120°C ohne Dampf

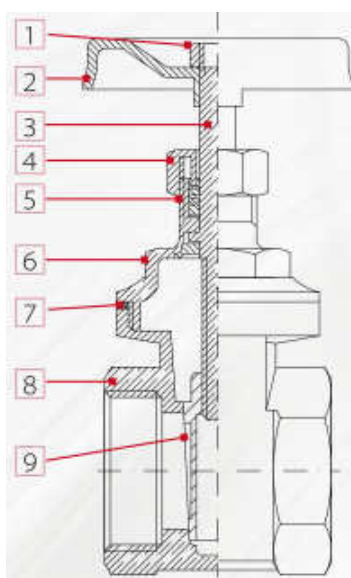

POS.	DESCRIZIONE/DESCRIPTION	Q.TÀ/N.	MATERIALE/MATERIAL
1	Dado / Nut	1	Ottone / Brass CW614N
2	Volantino / Handwheel	1	Acciaio / Steel
3	Asta / Stem	1	Ottone / Brass CW614N
4	Premistoppa / Gland	1	Ottone / Brass CW614N
5	Guarnizione / Washer	1	EPDM 90
6	Vitone / Bonnet	1	Ottone / Brass CW617N
7	Guarnizione / Washer	1	Fibra / Guarnita
8	Corpo / Body	1	Ottone stampato / Hot pressed brass CW617N
9	Tenuta / Seat	1	Ottone stampato / Hot pressed brass CW617N

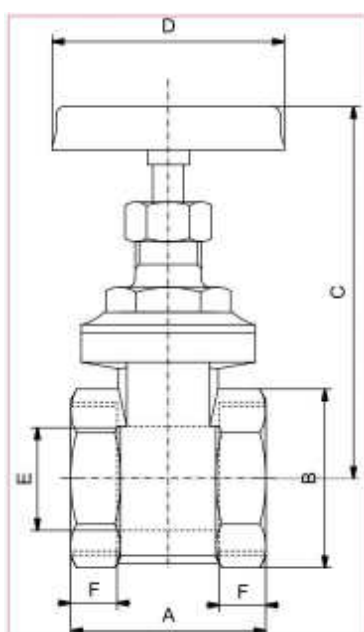

MISURE / SIZE	1/2"	3/4"	1"	1 1/4"	1 1/2"	2"	2 1/2"	3"	4"
DN	15	20	25	32	40	50	65	80	100
A (mm)	43	46	52	58	59	67	73	84	98
B (mm)	30	36	44	54	62	76	93	107	140
C (mm)	68	78	93	108	125	143	175	205	235
D (mm)	45	45	50	55	60	70	100	100	120
E (mm)	15	19	24	32	37	47	60	72	93
F (mm)	10	11	13	14	14	16	17	19	22
PRESS. ATMOSF./WORK PRESS. Kg/cm ² - bar	20	20	20	20	20	20	20	20	20
PRESS. ATMOSF. PSI LBS WORK PRESS.	290	290	290	290	290	290	290	290	290